



81 Black Prince Road, London
SE1

GARTON JONES.COM



81 Black Prince Road, London
, SE1

£550 Per Week

A fantastic 1-bedroom apartment of approx. 435sq.ft (40,2.7sq.m) in Parliament House, a popular residential complex, moments from the River Thames. The apartment is offered furnished to a high standard and comprises an open plan reception room, modern integrated kitchen, double bedroom, luxury bathroom and good storage. Residents will also enjoy a concierge service, exclusive gymnasium, designer interiors and cycle storage. Parliament House is a 23-storey tower within easy reach of the excellent transport services of Vauxhall including rail, tube, and bus links as well as a river taxi pier at St George Wharf. London's trendy South Bank is also close by offering many restaurants, bars, and theatres all within a short walk.

Please note furniture may differ to that shown in the current photos.

Disclaimer: Please note that this building is scheduled to undergo cladding remedial works in the near future. While every effort will be made to minimise inconvenience, potential disruption may occur during these works. Further details can be provided upon request. Please note furniture may differ to that shown in the current photos.

- Electricity Supply — Mains | Water Supply — Mains | Sewerage — Mains | Heating — Underfloor Heating
- Broadband & Mobile Signal : Check Coverage via Ofcom
- Parking: No Parking
- Lift Access
- Building Safety: EWS1 Available on Request
- Council Tax Band E (London Borough of Lambeth)
- 5 Week Security Deposit
- Holding deposit equivalent to 1 week of rent
- Rent to be payable monthly in advance
- EPC Rating TBC

- 1 Bedroom
- 435sq.ft (40sq.m)
- 1 Bathroom
- South Facing
- Open Plan Reception
- Floor-to-Ceiling Windows
- Day Porter
- Residents Gym
- Bicycle Storage
- 0.6 Miles to Vauxhall Station

GARTON JONES.COM

9 Albert
Embankment
London
SE1 7SP

Lettings:
+44 (0) 20 7735 1888
nineelms@gartonjones.com
www.gartonjones.com

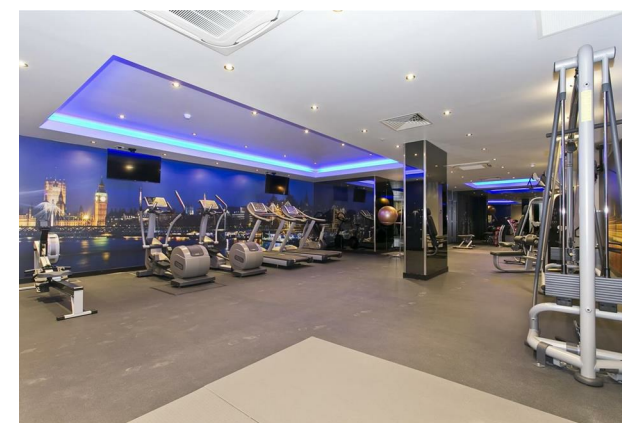

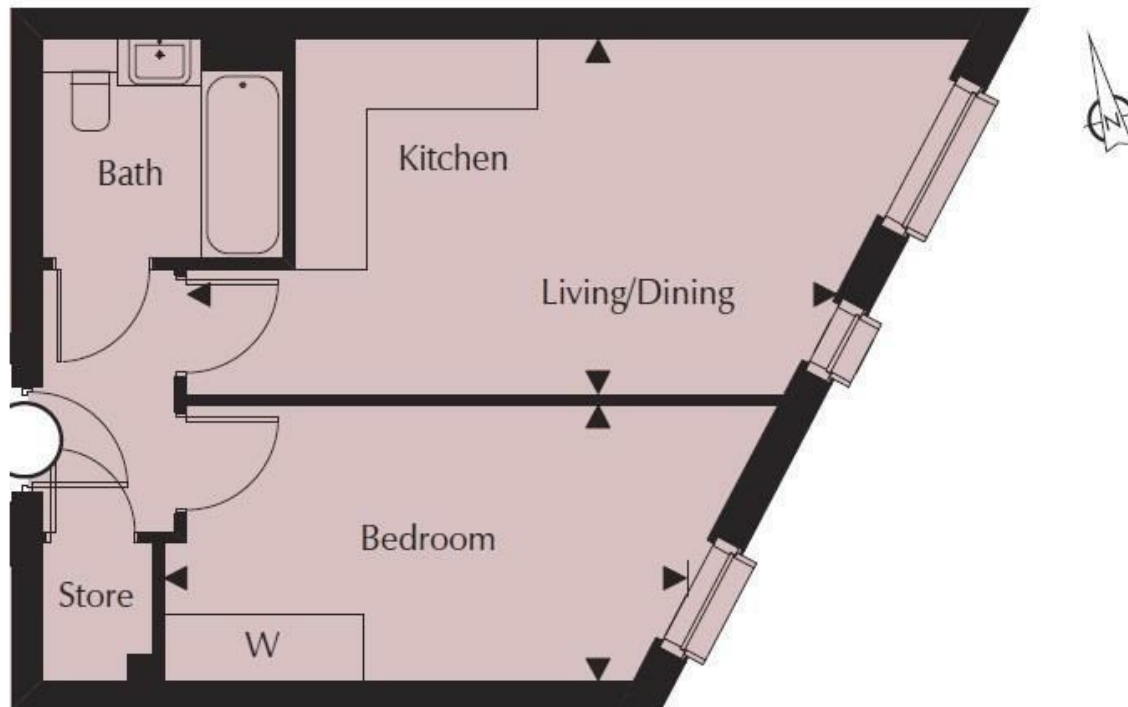

APARTMENT

Kitchen/Living/ Dining	5.88m x 3.24m	19'3" x 10'7"
Bedroom	4.75m x 2.49m	15'7" x 8'2"
Total Area	40.4 sq m	435 sq ft



